

# IPFW Wireless Express Setup



Student, faculty, and staff instructions for connecting to IPFW Student or IPFW Faculty Staff. [Visitor access info...](#)

## Wireless Configuration for Windows 10

A [PDF download](#) of these instructions is available for your convenience.

**Note:** You may be prompted during the configuration process to choose whether the new connection is a **Home, Work, or Public location**. This setting controls the security for the wireless connection and it is recommended that you select **Public location** for maximum security.

1. Click the wireless icon in the bottom right corner.



2. Select the **IPFW Faculty Staff** or **IPFW Student** wireless network.



3. Click **Connect**.
4. Enter your IPFW username and password.

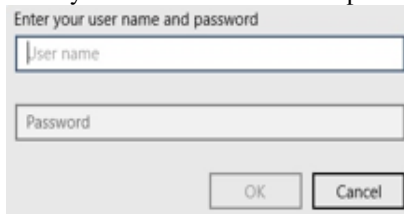

5. Click **OK**.
6. Click **Connect** at the prompt to continue connecting.



7. Once connected, you now must verify the security properties. Right-click on the Wi-Fi icon, in the system tray, and choose **Open Network and Sharing Center**.

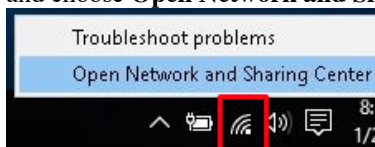

8. Click on the link for the Wi-Fi connection (**IPFW Faculty Staff** or **IPFW Student**)

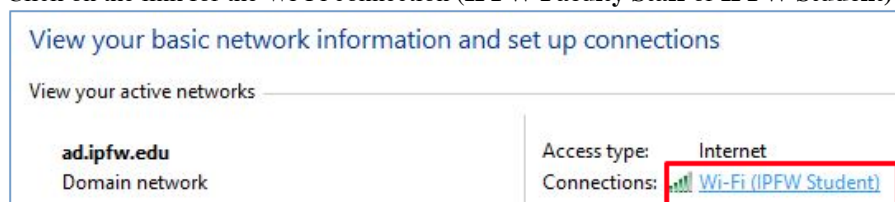

9. Click on the **Wireless Properties** button in the center of the window.

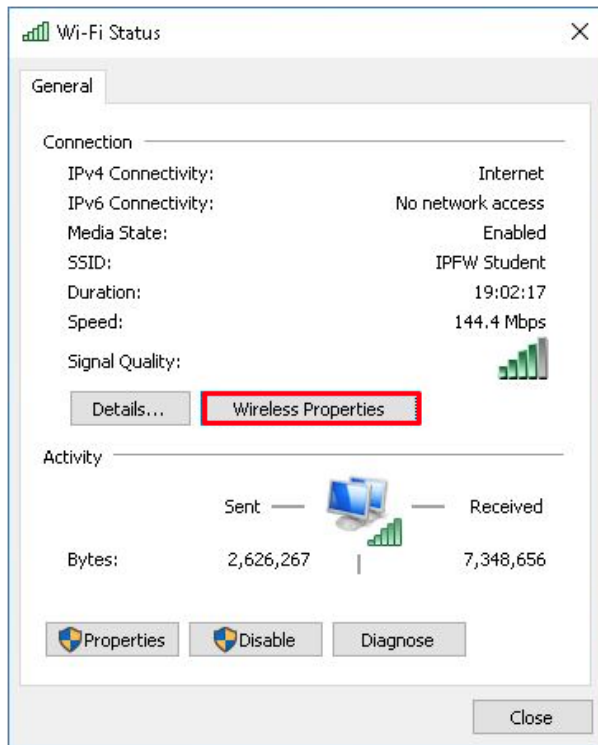

10. Click on the **Security** tab at the top, then then **Settings** button in the center- right of the window.

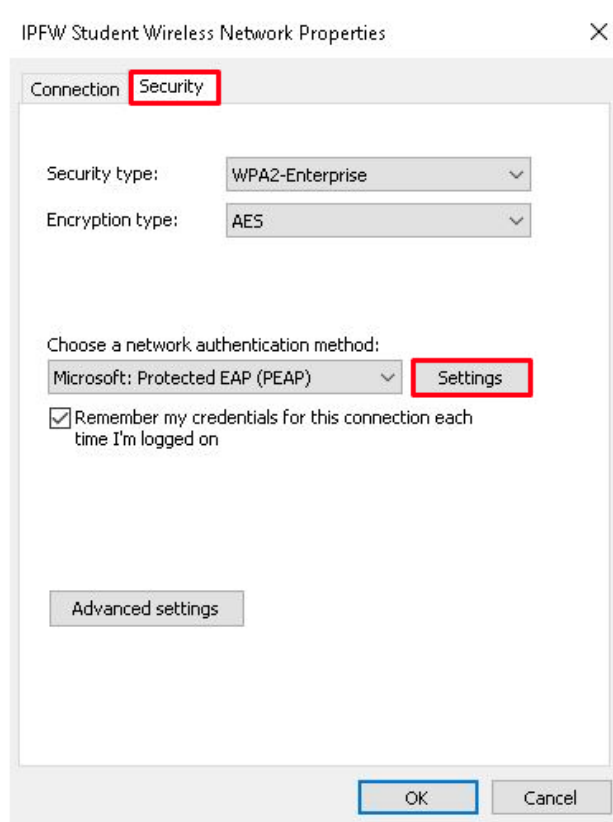

11. Un-check the top box for “Verify the server’s identity”, then click OK to close this window.

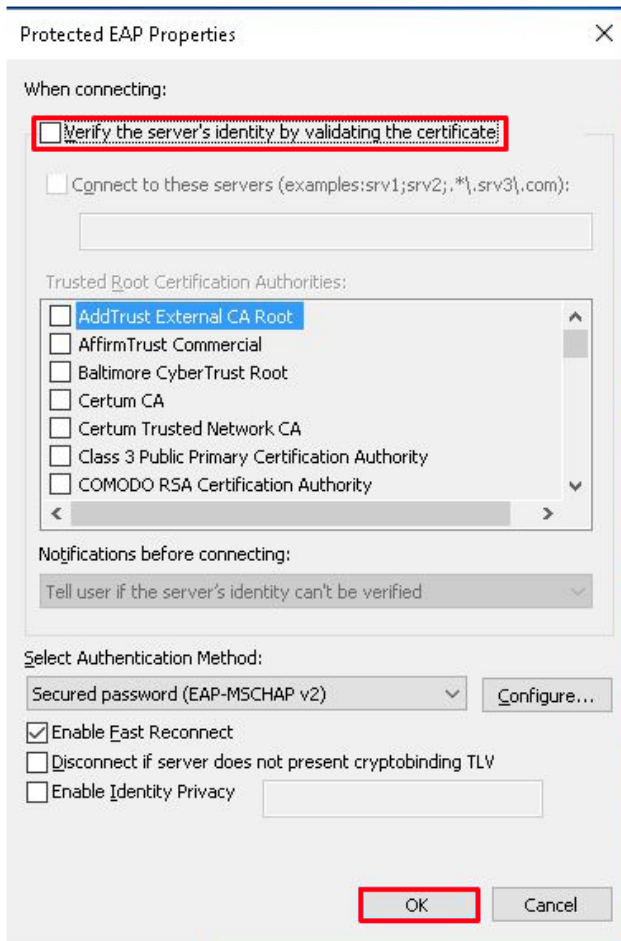

12. Click on the **Advanced Settings** button near the bottom of the window.

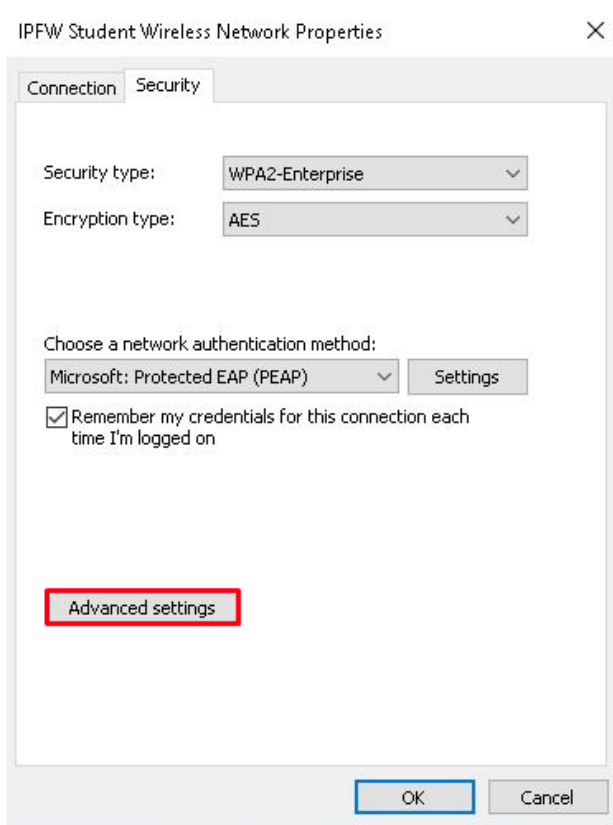

13. Change the top drop-down box from “User or computer authentication” to show “User authentication

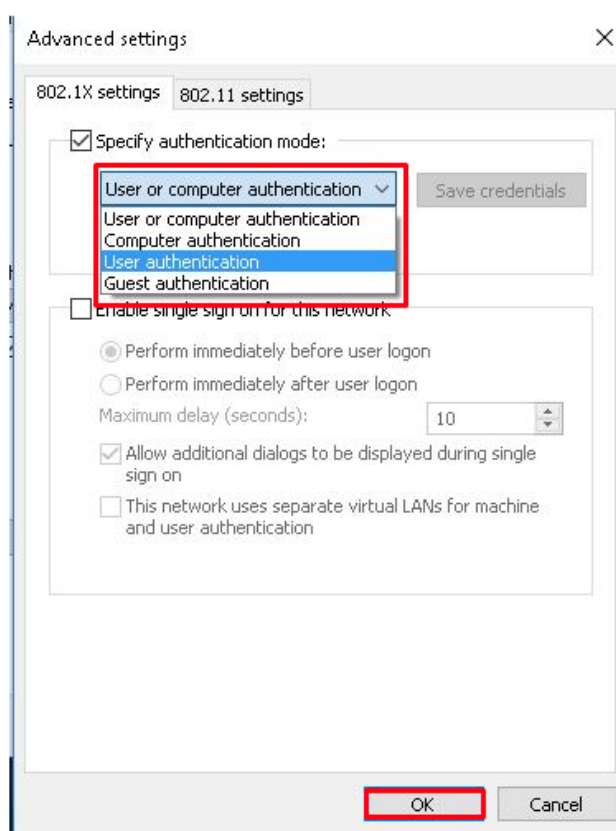

14. Click OK on all windows to close them out. You will be disconnected from the wireless because of the security changes. Reconnect to the wireless like normal, and you will stay connected.

**For more help...**